



*Come home  
to exclusivity.*

**PANCHSHEEL**  
**PRIME 390**

LOW-RISE FLOORS AT PANCHSHEEL PRIMROSE, GZR.



## A PERFECT COMBINATION.

These well-appointed low-rise floors are part of Primrose, a modern gated residential project already a home to many families. Here you get to enjoy the facilities and amenities of group housing without having to compromise on anything. Come, indulge in an independent lifestyle that gives you the freedom of privacy and living as per your own choice.

Disclaimer: Visual representation of images and elevation shown in this brochure are purely conceptual. All plans, specifications, layouts etc. are tentative and subject to variations and modifications by the company or the competent authorities and company does not bear any legal consequences for it. The areas are approx. 1 sq. mt. = 10.764 sq.ft. (10.764 sq.ft. = 1.0 sq.mt. = 10<sup>6</sup> sq.mm.) we are RERA compliant



## FEATURES

Low-rise floors with the facilities of a group housing project • G+4, Two side open 3 BHK Floors, • Shopping convenience for daily needs • Parks with play area, walking & jogging tracks • Spacious and well ventilated rooms with windows open to fresh air • Rain water harvesting • Reserved car parking • Power back up facility • 24hrs. water supply in bathrooms & kitchen • Dedicated lift for each tower • In house club with modern facilities • Round the clock security with intercom.

*Low-rise Floors with Big Verandas  
and Group Housing Facilities.*

Actual Site images of Low-Rise Floors







# SITE PLAN



**RERA Regn. Nos. of Projects : Phase - IV UPRERAPRJ8687**  
**For Details visit RERA website: [www.up-rera.in](http://www.up-rera.in)**

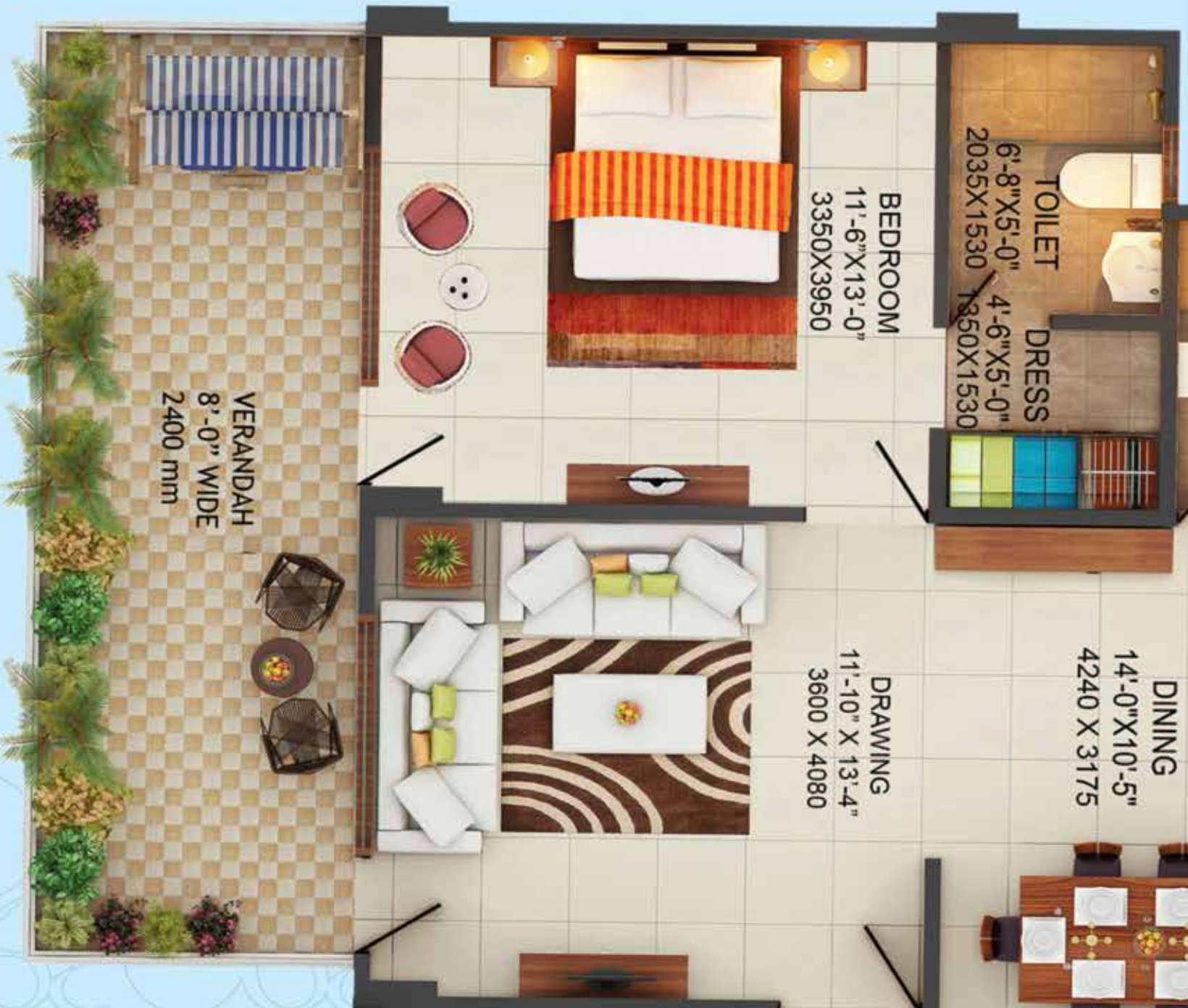

**HIG-I / 3BHK + DRESS**

3 Bedrooms

Dress

3 Toilets

2 Balconies

Area	Sq. Ft.	Sq. Mt.
<b>Carpet</b>	<b>993.19</b>	<b>92.27</b>
Built-up	1286.94	119.56
Salable	1640.00	152.36



# SPECIFICATIONS



## **WATER SUPPLY**

Underground and overhead water tanks with pumps for 24 hours uninterrupted water supply.



## **INTERNAL /EXTERNAL FINISH**

All internal walls plastered & painted in off-white shade of oil bound distemper, Plaster of Paris punning & cornices in drawing/dining room and bedrooms. Most modern & elegant permanent outer finish with high quality texture paint.



## **DOORS / WINDOWS**

All external doors and window frames in UPVC.



## **KITCHEN**

Ceramic glazed tiles up to 2 feet height above counter. Pre-polished granite platform with stainless steel sink.



## **ELECTRICAL**

ISI copper wiring in P.V.C. concealed conduit. Provision for adequate light and power points as well as telephone & TV outlets with protective M.C.Bs.



## **TOILETS**

Provision for hot & cold water system. Glazed tiles in pleasing colours on walls up to door level. European WC, washbasin & cistern in white shade in all toilets.



## **STRUCTURE**

Earthquake resistant R.C.C. framed structure certified by IIT.



## **HARDWARE**

All fittings with aluminum powder coated materials.



## **FLOORING**

Vitrified tiles.

# Panchsheel Group. Building Future.

World-class residential & commercial projects in Noida, Greater Noida, Vaishali & Ghaziabad

Nearly 3 decades  
of strong standing

10000 + Possessions  
Given Till Date

Thousands of  
Satisfied Customers

## Delivered Projects



Actual View

**PANCHSHEEL Wellington**  
IN AEROSPACE PROJECTS  
215 BEDROOM APARTMENTS  
Crossings Republik, Ghaziabad



Actual View

**PANCHSHEEL PRIMROSE**  
2/3 BR Apts. Opp. Govindpuram, Anand Market, GZB.



Phase - I Delivered

Actual View

**PANCHSHEEL PRIME 390**  
LOW-RISE FLOORS AT PANCHSHEEL PRIMROSE, GZB.  
Low-rise (G+4 Storied) 3 BHK apartments with 8ft. wide verandah



Actual View

**PANCHSHEEL HYNISH**  
2/3 BR Homes Sec-1, Gr. Noida (W)



Actual View

**PANCHSHEEL Pebbles**  
Homes near Vaishali Metro Sta., Sector 3, Vaishali, GZB



Actual View

**PANCHSHEEL Well Bazaar**  
A5 Wellington, Crossings Republik, Ghaziabad



Actual View

**PANCHSHEEL SQUARE**  
SHOPS OFFICE SPACES FOOD COURT  
Crossings Republik, Ghaziabad



Actual View

**PANCHSHEEL Greenaria**  
Plot No. GH-01A, Sector 16B, Gr. Noida (W)



Actual View

**Hynish Commercial**  
**PANCHSHEEL HYNISH**  
2/3 BR Homes Sec-1, Gr. Noida (W)



Actual View

**PANCHSHEEL GREENS**  
Plot No. GH-01A, Sector 16B, Gr. Noida (W)



Delivered Tower F2 & F3

Actual View

**PANCHSHEEL PINNACLE**  
Live above everything else  
Plot No. GH-01A, Sector 16B, Gr. Noida (W)  
High-rise apartments  
Aluminium shuttering used for better construction Quality.



Actual View

**PANCHSHEEL**  
The name is the address  
2/3 BR HOMES Sec-75, Noida  
Aluminium shuttering used for better construction Quality.



Phase - I Delivered

Actual View

**PANCHSHEEL GREENS-II**  
2/3 BR Apts. Opp. Govindpuram, GZB.  
Plot No. GH-01A, Sector 16, Gr. Noida (W)

## Ongoing Projects



Actual View

**PANCHSHEEL PRIME 390**  
LOW-RISE FLOORS AT PANCHSHEEL PRIMROSE, GZB.  
Low-rise (G+4 Storied) 3 BHK apartments with 8ft. wide verandah



Actual View

**PANCHSHEEL PINNACLE**  
Live above everything else  
Plot No. GH-01A, Sector 16B, Gr. Noida (W)  
High-rise apartments  
Aluminium shuttering used for better construction Quality.



Actual View

**PANCHSHEEL GREENS-II**  
2/3 BR Apts. Opp. Govindpuram, GZB.  
Plot No. GH-01A, Sector 16, Gr. Noida (W)



Actual View

**Panchsheel Villas**  
Plot No. GH-01A, Sector 16, Gr. Noida (W)



Actual View

**PANCHSHEEL GREENMART**  
Plot No. GH-01A, Sector 16, Gr. Noida (W)

Disclaimer: Visual representation of images and elevation shown in this brochure are purely conceptual. All plans, specifications, layouts etc. are tentative and subject to variations and modifications by the company or the competent authorities and company does not bear any legal consequences for it. The areas are approx. 1 sq. mt. = 10.764 sq.ft. (10.764 sq.ft. = 1.0 sq.mt. = 10<sup>3</sup> sq.m.m.) we are RERA compliant

# LOCATION MAP



## Location Advantages

- Ghaziabad Railway Station - 7 kms.
- New Ghaziabad Railway Station - 3 kms.
- Old Bus Stand - 4 kms.
- CGO Complex - 2 kms.

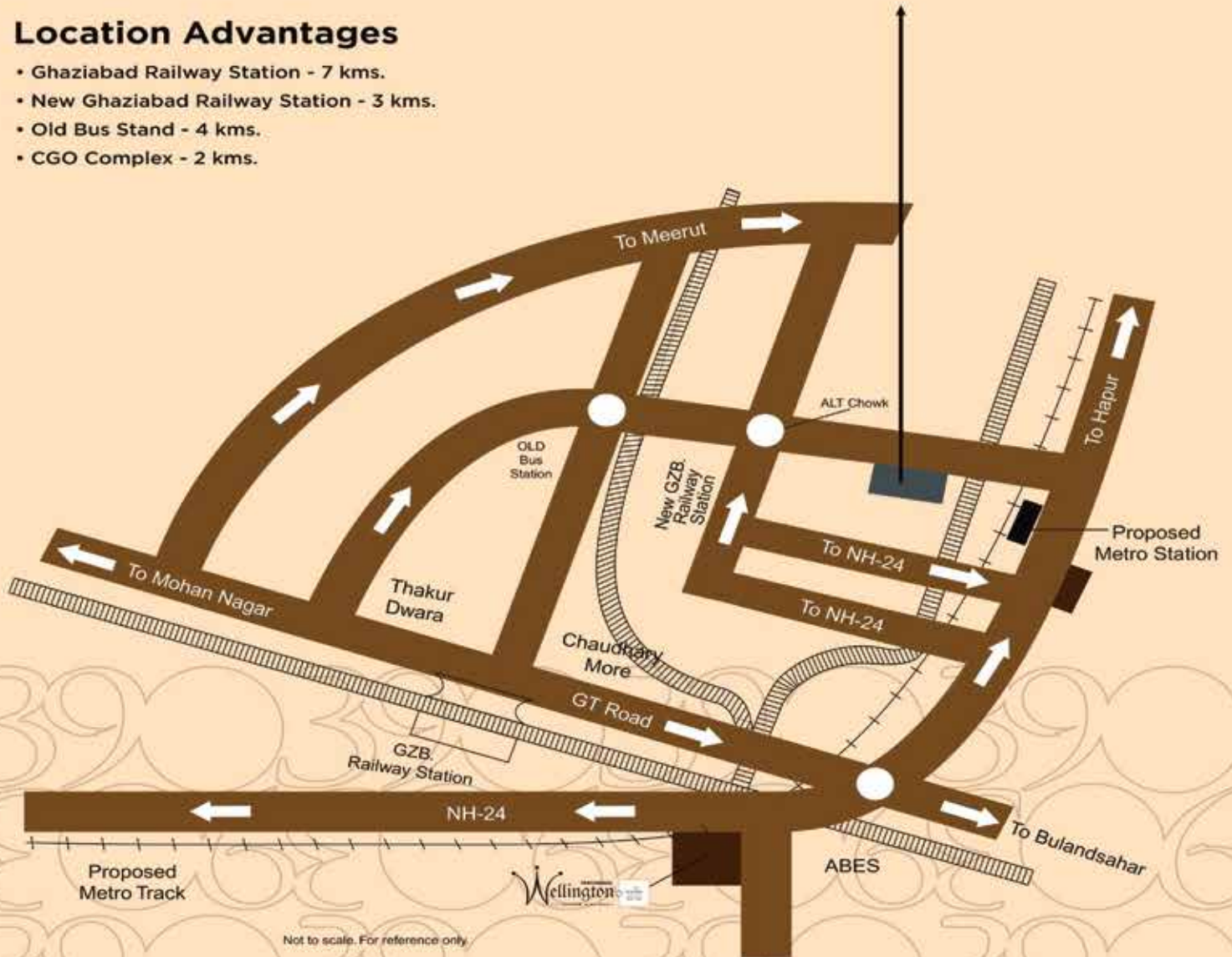

Not to scale. For reference only.



**Panchsheel Buildtech Pvt. Ltd.**

(ISO 9001:2008 Company)

**Corporate Office:** G-34, Sector-63, Noida - 201301. | **T:** 0120-4777700 / 0120-4777777 (15 Lines) | **F:** 0120-4777798

**Site Address:** Panchsheel Prime390 at Panchsheel Primrose, Near Police Line, Ghaziabad.

**E:** sales@panchsheelgroup.com | **Toll Free No.:** 1800-120-00 3656 | **W:** www.panchsheelgroup.com

**Sales Enquiry No. 7827 789 789**



Disclaimer: Visual representation of images and elevation shown in this brochure are purely conceptual. All plans, specifications, layouts etc. are tentative and subject to variations and modifications by the company or the competent authorities and company does not bear any legal consequences for it. The areas are approx. 1 sq. mt. = 10,764 sq. ft. (10,764 sq. ft. = 1.0 sq. mt. = 10' sq. mm.) we are REPA compliant

1000/01/2024 PBPL